



RANGE HOODS

ATTIC VENTILATORS

AIR EXCHANGERS

DELUXE RANGE HOODS

For more than 25 years, Venmar Ventilation has been one of North America's leading manufacturers of innovative Indoor Air Quality products for commercial and residential applications.

Today, with over one million homeowners among its customers, Venmar continues to manufacture a full range of products. From kitchen range hoods and attic ventilators to filtration and ventilation systems, all of our products are recognized as the industry standard for quality, styling, reliability, and an optimally healthy indoor air environment.

Your complete source of information on Venmar AVS air exchangers

Constructo:
1.0 / 1.5 / 2.0

Solo:
1.5 / 2.0

Duo:
1.2 / 1.4 / 1.9

HE:
1.3 / 1.8 / 2.6

SPECIFICATIONS	Constructo			Solo		Duo			HE		
	1.0	1.5	2.0	1.5	2.0	1.2	1.4	1.9	1.3	1.8	2.6
Rate of air flow (cfm)* (low/high)	HRV - 45 - 96 cfm ERV - 45 - 99 cfm	64-150 cfm	117-189 cfm	64-150 cfm	117-189 cfm	64-117 cfm	64-120 cfm	117-180 cfm	65-130 cfm	115-197 cfm	180-321 cfm
Filter	Washable foam filters	Washable foam filters	Washable foam filters	Washable foam filters at time of purchase. Optional pleated, charcoal or electronic filters available	Washable foam filters at time of purchase. Optional pleated, charcoal or electronic filters available	Washable foam filters at time of purchase. Optional pleated, charcoal or electronic filters available	Washable foam filters at time of purchase. Optional pleated, charcoal or electronic filters available	Washable foam filters at time of purchase. Optional pleated, charcoal or electronic filters available	Washable aluminum filters	Washable foam filters	Washable foam filters
Diameter for fresh air supply to inside port and for stale air exhaust from inside port	5" (12.5 cm)	6" (15 cm)	6" (15 cm)	6" (15 cm)	6" (15 cm)	6" (15 cm)	6" (15 cm)	6" (15 cm)	7" (18 cm)	8" (20 cm)	8" (20 cm)
Diameter for fresh air supply from outside port and for stale air exhaust to outside port	5" (12.5 cm)	6" (15 cm)	6" (15 cm)	6" (15 cm)	6" (15 cm)	6" (15 cm)	6" (15 cm)	6" (15 cm)	6" (15 cm)	6" (15 cm)	6" (15 cm)
Voltage	120 V	120 V	120 V	120 V	120 V	120 V	120 V	120 V	120 V	120 V	120 V
Power	135 W	150 W	240 W	150 W	240 W	160 W	160 W	250 W	115 W	250 W	500 W
Dimensions	Height 12-3/16 in. (31 cm) Width 22-9/16 in. (57.4 cm) Depth 19-13/16 in. (50.3 cm)	16-1/2 in. (42 cm) 30-1/4 in. (76.8 cm) 17-1/8 in. (43.5 cm)	16-1/2 in. (42 cm) 30-1/4 in. (76.8 cm) 17-1/8 in. (43.5 cm)	16-1/2 in. (42 cm) 30-1/4 in. (76.8 cm) 17-1/8 in. (43.5 cm)	16-1/2 in. (42 cm) 30-1/4 in. (76.8 cm) 17-1/8 in. (43.5 cm)	16-1/2 in. (42 cm) 30-1/4 in. (76.8 cm) 17-1/8 in. (43.5 cm)	16-1/2 in. (42 cm) 30-1/4 in. (76.8 cm) 17-1/8 in. (43.5 cm)	16-1/2 in. (42 cm) 30-1/4 in. (76.8 cm) 17-1/8 in. (43.5 cm)	27 in. (68.6 cm) 21 in. (53.3 cm) 24-1/4 in. (61.6 cm)	42-3/4 in. (108.6 cm) 23 in. (58.4 cm) 24 in. (60.1 cm)	42-3/4 in. (108.6 cm) 23 in. (58.4 cm) 24 in. (60.1 cm)
Weight (approx.)	HRV: 39 lb (17.7 kg) ERV: 45 lb (20.4 kg)	65 lb (29.5 kg)	67 lb (30.5 kg)	65 lb (29.5 kg)	67 lb (30.5 kg)	68 lb (31 kg)	65 lb (29.5 kg)	68 lb (31 kg)	80 lb (36.3 kg)	140 lb (63.5 kg)	140 lb (63.5 kg)
Type of recovery	HRV or ERV	HRV	HRV	HRV	HRV	ERV	ERV	ERV	HRV	HRV	HRV
Main wall control options (Sold separately)	Lite-Touch Constructo, Constructo or directly on unit	Lite-Touch Constructo, Humidity Control, Constructo or directly on unit		Supra, Venta or Ultima			Supra, Venta or Ultima			Supra, Venta or Ultima	
Optional wall controls (Sold separately)	20-min. lighted push-button or 60-min. mechanical timer			60-min. mechanical timer or 20/40/60-min. push-button			60-min. mechanical timer or 20/40/60-min. push-button			60-min. mechanical timer or 20/40/60-min. push-button	
HVI Certified (Home Ventilating Institute)	YES	YES	YES	YES	YES	YES	YES	YES	YES	YES	YES
Warranty on core or enthalpy wheel	HRV - Limited Lifetime ERV - 5 years	Limited Lifetime	Limited Lifetime	Limited Lifetime	Limited Lifetime	5 years	5 years	5 years	Limited Lifetime	Limited Lifetime	Limited Lifetime
Warranty on parts	2 years	2 years	2 years	5 years	5 years	5 years	5 years	5 years	5 years	5 years	5 years

* cfm: Cubic feet per minute

AVAILABLE AT THIS AUTHORIZED DEALER

Specifications subject to change without notice.



Proud Member of the Healthy Indoors Partnership
A multi-sectoral collaboration and partnership to create and maintain healthier indoor environments in Canada.



Venmar Ventilation inc.
Residential Product Group
550 Lemire Blvd., Drummondville
QC, Canada, J2C 7W9
Toll-free: 1-800-567-3855 (Canada & U.S.A.)
www.venmar.ca



7 172371 108552 17
91027 02/05



Your complete source of information on Venmar AVS air exchangers

Table of contents

Introduction	2-3
Constructo 1.0	4-5
Constructo 1.5 / 2.0	6-7
Solo 1.5 / 2.0	8-9
Duo 1.2 / 1.4 / 1.9	10-11
HE 1.3 / 1.8 / 2.6	12-13
Installations	14-15



Venmar AVS—The Professionals' Choice

Over twenty-five years committed to redefining ventilation by combining innovative technology and engineering expertise—exclusively for HVAC professionals—has resulted in the creation of Venmar AVS, the most advanced line of air exchangers designed to exceed the ventilation requirements of builders, remodelers and homeowners across North America.

These state-of-the-art units have many exciting features and options to customize the unit's performance to better suit any air exchange need.

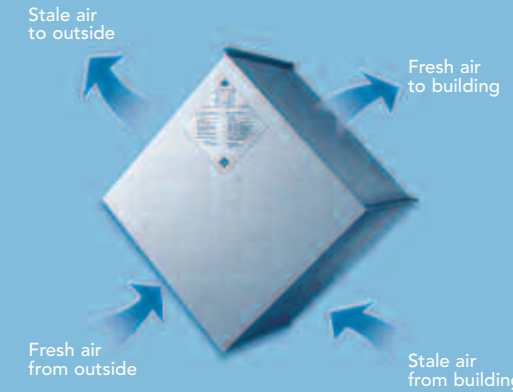

Heat Recovery

Moisture-proof polypropylene core expels excess humidity that occurs especially during the cold seasons, helping prevent potential health problems as well as moisture damage to window frames and surrounding walls.

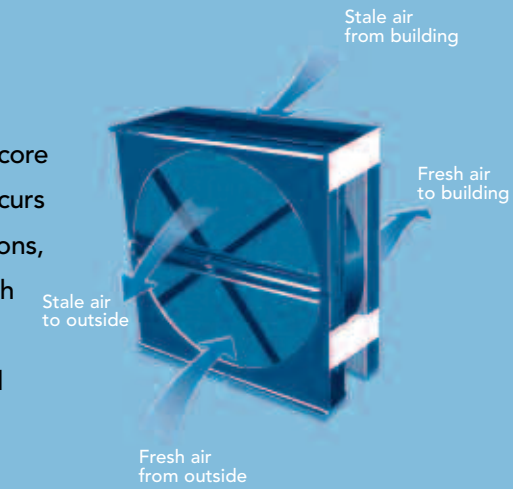

Energy Recovery

Transfers heat and moisture from one airstream to another, thereby optimizing energy recovery and maintaining proper humidity levels in your home. Excellent for year-round use in homes with air conditioning and in areas where outdoor humidity levels are high.

Getting the most out of your air exchanger

Before choosing a Venmar AVS air exchanger there are a few things homeowners and builders must consider, such as the importance of maintaining neutral indoor air pressure and how climate plays a crucial role in determining which type of air exchanger will provide the most benefit to a home's indoor air environment.

Equalizing Indoor Air Pressure: A Crucial Balancing Act

It is important not to neglect the impact of an unbalanced ventilation system. If an air exchange unit does not expel and intake equal amounts of air, a negative or positive air pressure imbalance occurs.

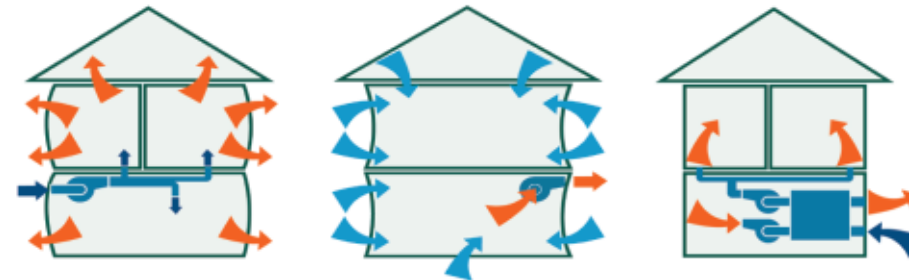

Positive air pressure

- Pushes hot and/or humid air into walls and insulation; condensation can lead to mold, mildew and rot
- Heat loss

Negative air pressure

- Cold air infiltrates house
- May increase energy costs
- May cause combustion appliances to backdraft

Equal air pressure

- Supply airflow is equal (CFM) to stale air exhaust
- Balancing is required on all units unless specified otherwise.

Different Climates

Create different indoor air ventilation needs

Depending on your home's geographical location, you will need to install one of the following categories of air exchanger: A Heat Recovery Ventilator (HRV) or an Energy Recovery Ventilator (ERV).

HRV - Heat Recovery Ventilator

Ideal for colder climates

In colder climates, where home heating is essential, the heat recovery ventilator (HRV) is the proper choice. The HRV keeps the home supplied with a steady flow of fresh outdoor air. As stale, warm air is expelled, the heat recovery core warms the incoming fresh, colder air before it is distributed throughout the home. The result is a constant supply of fresh air, no unpleasant drafts and greater home comfort. In addition to heat recovery and improved air quality, the HRV provides necessary ventilation while controlling excess humidity.

ERV - Energy Recovery Ventilator

Ideal for warmer climates and high-humidity environments

Even though the energy recovery ventilator (ERV) is suitable for colder climates, it is usually associated with warmer climate homes where humidity control is important. The ERV recovers heat (like the HRV); however, it also recuperates the energy trapped in moisture, which greatly improves the overall recovery efficiency. The ERV process is as follows: In humid climates and air conditioned homes, when it is more humid outside than inside, the ERV limits the amount of moisture coming into your home. In dry climates and humidified homes, when the humidity level is reversed, the ERV limits the amount of moisture expelled from your home.

Constructo 1.0

The Space Saving System



An ingenious air exchange solution that's as versatile as it is compact

Configured with factory built vertical or horizontal ports, the Constructo 1.0 can fit almost anywhere. Tucked in a bulkhead or closet, it's the most versatile 100 CFM unit available on the market today. This compact, lightweight, and powerful unit is the ideal choice for small pre-fab and tract houses, condos, apartments and other limited space applications. What's more, it is the only air exchanger of its size that can be upgraded from an HRV to an ERV, simply by changing its core.

- Ideal for new residential construction or renovation projects where available space is limited
- 20% smaller than comparable units
- Available with horizontal or vertical ports (factory-configured)
- Simple to install
- Easy to maintain
- State-of-the-art ventilation technology
- Upgradable from a heat recovery to an energy recovery ventilator (HRV to ERV) with a simple swap of its core



Features	HRV	ERV
Rate of air flow (low/high):	45-96 CFM	45-99 CFM
Apparent sensible effectiveness at 0°C (32°F):	76% @ 30 l/s (64 CFM)	77% @ 30 l/s (64 CFM)
Apparent sensible effectiveness at -25°C (-13°F):	81% @ 30 l/s (64 CFM)	77% @ 30 l/s (64 CFM)
Dimensions: (Height X Width X Depth)	12-3/16 in. x 22-9/16 in. x 19-13/16 in. (31 cm x 57.4 cm x 50.3 cm)	
Warranty on Parts:	2 years	2 years
Warranty on Core:	Limited Lifetime	5 years

Unique ERV Core

Patent pending counter cross-flow energy recovery core technology provides the most effective efficiency/volume ratio of all the units of its category.

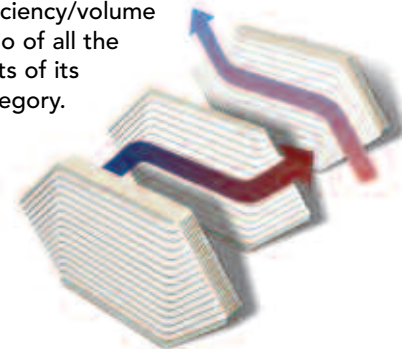

Lite-Touch Constructo Wall Control

Easy to use 3-mode wall control (MIN/ MAX/ INTERMITTENT: 20-min ON/40-min OFF)



Part # 40370

Other available wall controls: Simple-Touch Constructo (#40390), and Constructo (#40350).

Bulkhead Installation

Unique slim design lets you hide unit inside standard 12" bulkheads*. Easily install and access unit through ceiling grille.

* ERV only.

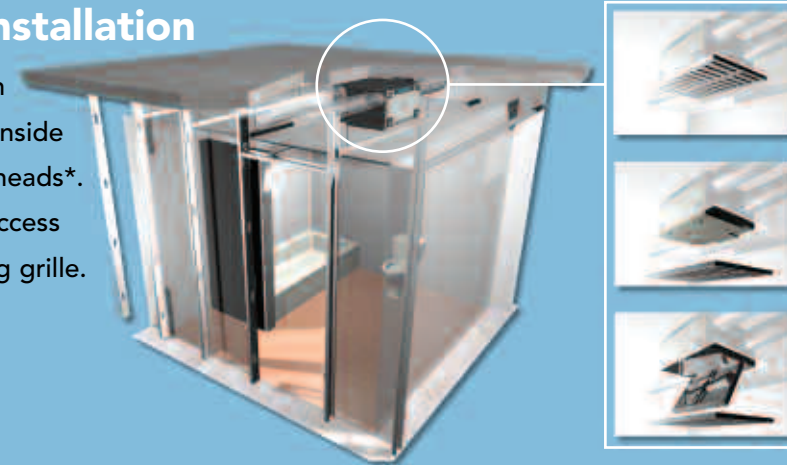

Closet and Utility Room Installation

Compact footprint allows for an easy fit in mechanical rooms, closets or other applications where overall space is restricted.

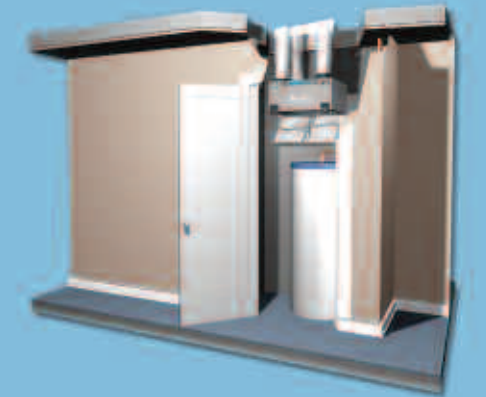

Easy to Reach Filters

Washable foam filters effectively filter airborne particles, such as pet dander, lint, dust and mold spores, while protecting the equipment from dust build-up.

Interchangeable Core

Allows unit to be upgraded from an HRV to an ERV, and vice versa, without additional mechanical adjustments.

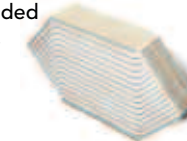

HomeShield™ Defrosting System

Prevents ice build-up on recovery module without creating negative indoor air pressure.

Flexible Port Configuration

Versatile design allows for vertical or horizontal port configuration, facilitating installation and maintenance. (Factory-configured)



Removable Electrical Drawer

Remove one screw to release and access the electronics with pull out PCB assembly for easy maintenance of major sub-components.



Intelligent Flow Dampers

The fresh air intake port is equipped with a damper controlled by an intelligent motor with integrated circuit logic. Easy to access. Easy to maintain. Very precise.



High-Pressure Blower

Designed to eliminate the need to balance unit in most simple installations.

Bottom Door Opening

Unique bottom door opening design allows parallel duct connection for easy access from any angle.



Patented Balancing System

Patented pressure taps eliminate the need for an external flow meter and reduce installation time.

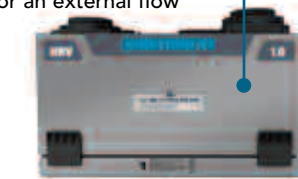

Constructo 1.5 / 2.0

The Affordable System



For improved indoor air quality at an affordable price

The number one choice for new residential construction in North America, Constructo air exchangers offer effective heat recovery, proper ventilation flow and quiet operation at a value-conscious price. Ideal for mid-size to large homes, Constructo units improve indoor air quality and reduce excess humidity by bringing a steady flow of fresh outdoor air into the home.

- Designed for new residential construction
- Offer standard ventilation features to meet codes and standards at an affordable price
- Equipped with a heat recovery core (HRV)

Features	1.5	2.0
Rate of air flow (low/high):	64-150 CFM	117-189 CFM
Apparent sensible effectiveness at 0°C (32°F):	81% @ 31 l/s (66 CFM)	70% @ 56 l/s (119 CFM)
Apparent sensible effectiveness at -25°C (-13°F):	80% @ 37 l/s (78 CFM)	80% @ 37 l/s (78 CFM)
Dimensions: (Height X Width X Depth)	16-1/2 in. x 30-1/4 in. x 17-1/8 in. (42 cm x 76.8 cm x 43.5 cm)	
Warranty on Parts:	2 years	
Warranty on Core:	Limited Lifetime	

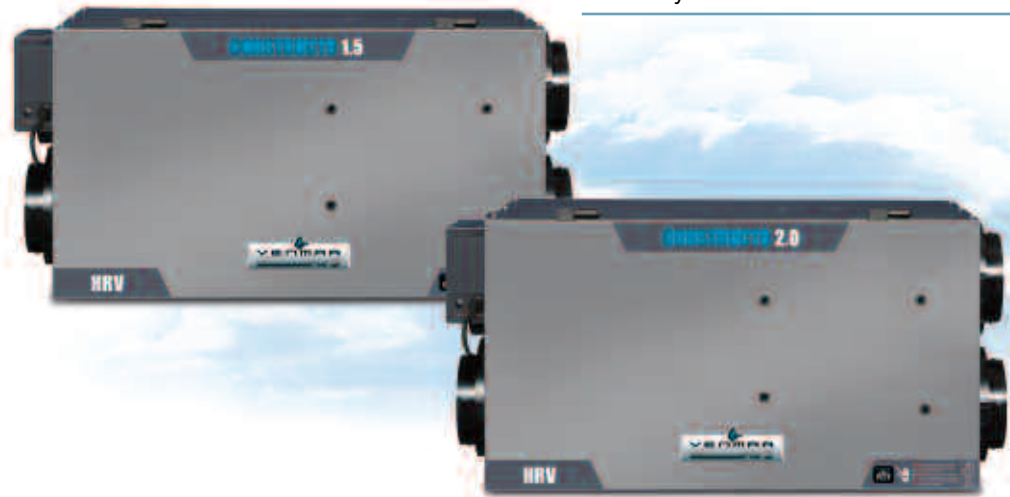

Main Wall Controls

To help maintain a consistently high level of indoor air quality, Constructo units require one of the following main wall controls.



Humidity Control

Controls excess humidity during Fall, Winter and Spring. This control is graduated in relative humidity percentage degrees. Part # 11297



Constructo

Includes two operating modes, minimum and maximum, and dehumidistat switch. Part # 40350



Lite-Touch Constructo

Easy to use 3-mode wall control (MIN/ MAX/ INTERMITTENT: 20-min ON/ 40-min OFF) Part # 40370

Optional Controls

For a more complete installation and to control ventilation in selected areas, choose one or more of these efficient controls.



60-Minute Mechanical Timer

This timer allows up to 60 minutes of high speed operation. Part # 00910



20-Minute Lighted Push-Button

This remote control turns the unit to high speed when excess humidity needs to be expelled. Part # 12030

External Electrical Box

Easy access to electronics on the exterior of unit for easy maintenance and installation.

HomeShield™ Defrosting System

Prevents ice build-up on recovery module without creating negative indoor air pressure.

Motor Assembly

Can easily be replaced in less than 7 minutes, allowing a simple and fast maintenance.

Door Switch

Door Switch automatically shuts off unit when door is opened for added safety and easy maintenance.



Heat Recovery Core

Offers superior home comfort by warming the incoming fresh, colder air before it is distributed throughout your home.

Core Maintenance

Enjoy quick and simple maintenance with a heat recovery core that is easy to remove and can be washed in water.

Easy to Reach Filters

Washable foam filters effectively filter airborne particles, such as pet dander, lint, dust and mold spores, while protecting the equipment from dust build-up.

Patented Balancing System

Patented pressure taps eliminate the need for an external flow meter and reduce installation time.



Solo 1.5 / 2.0

The Complete Comfort System



The comfortable home solution for improved indoor air quality

A very popular choice and one of the best heat recovery air exchangers (HRV) of its category, Solo air exchangers deliver an exceptional level of indoor air quality and excess humidity control. Featuring a robust polypropylene core, Solo units supply fresh air all year and retain heat in colder climates for improved home comfort. Optional filter upgrades are available to boost the filtration level while versatile main or optional wall controls make it easy to manage excess humidity and air flow throughout the home.

- Ideal for renovation and new residential construction
- Offer a complete solution to reduce excess humidity and expel gaseous pollutants
- Allow optional filter and wall control upgrades
- Offer air recirculation mode for a constant flow of air to prevent air stagnation (available with the Ultima control)
- Totally reversible units to simplify installation
- Equipped with a heat recovery core (HRV)

Features	1.5	2.0
Rate of air flow (low/high):	64-150 CFM	117-189 CFM
Apparent sensible effectiveness at 0°C (32°F):	81% @ 31 l/s (66 CFM)	70% @ 56 l/s (119 CFM)
Apparent sensible effectiveness at -25°C (-13°F):	80% @ 37 l/s (78 CFM)	80% @ 37 l/s (78 CFM)
Dimensions: (Height X Width X Depth)	16-1/2 in. x 30-1/4 in. x 17-1/8 in. (42 cm x 76.8 cm x 43.5 cm)	
Warranty on Parts:	5 years	
Warranty on Core:	Limited Lifetime	



Main Wall Controls

To help maintain a consistently high level of indoor air quality, Solo units require one of the following main wall controls.



Venta Model
Contains pull out tab with simple instructions and easy-to-use settings. Part # 40310



Supra Model
Includes maintenance light indicator, three operating modes and humidity indicator. Part # 40320



Ultima Model
Includes maintenance light indicator, six operating modes including a recirculation setting, and humidity indicator. Part # 40340

Optional Filters

Pleated Filter:

This non-woven, reinforced cotton and synthetic fabric filter traps more airborne pollutants than the standard filter for improved air quality.

Charcoal Filter:

The activated carbon in this filter effectively traps odors, gases and particles.

Electronic Filter:

This filter's electric field offers superior filtration by capturing 90% of particles as small as 1 micron (1 human hair = 150 microns).



Optional Controls

For a more complete installation and to control ventilation in selected areas, choose one or more of these efficient controls.



60-Minute Mechanical Timer
This timer allows up to 60 minutes of high speed operation. Part # 00910



20/40/60-Minute Push-Button
Provides three convenient settings to help control excess humidity. Part # 03364

External Electrical Box

Easy access to electronics, including microprocessor that is compatible with all controls, on the exterior of unit for easy maintenance and installation.

Permanent Memory

The electronic controls remember which control setting was in use even after a power failure.

HomeShield™ Defrosting System

Prevents ice build-up on recovery module without creating negative indoor air pressure.

Motor Assembly

Can easily be replaced in less than 7 minutes, allowing a simple and fast maintenance.

Door Switch

Door Switch automatically shuts off unit when door is opened for added safety and easy maintenance.

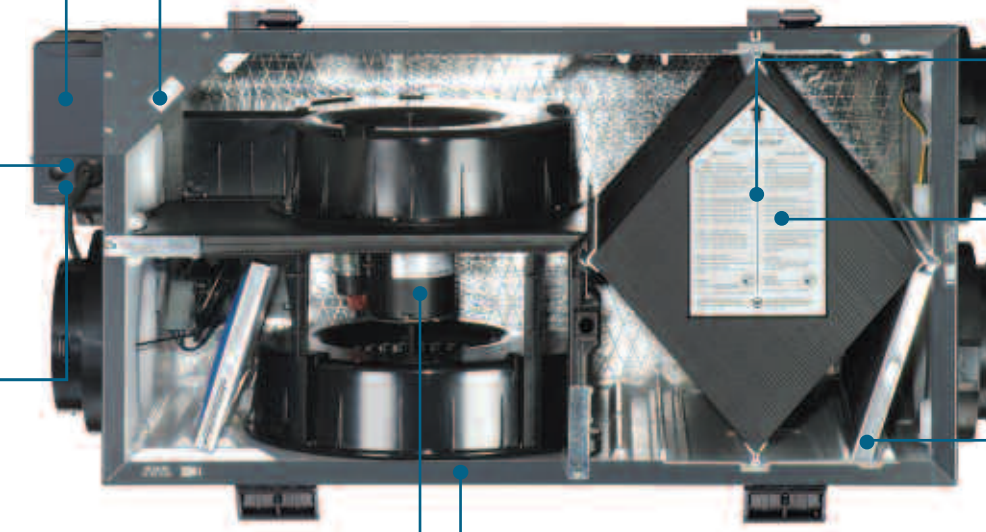

Heat Recovery Core

Offers superior efficiency by warming the incoming fresh, colder air before it is distributed throughout your home.

Core Maintenance

Enjoy quick and simple maintenance with a heat recovery core that is easy to remove and can be washed in water.

Easy to Reach Filters

Washable foam filters effectively filter airborne particles, such as pet dander, lint, dust and mold spores, while protecting the equipment from dust build-up.

Totally Reversible Unit

The two ports for exterior connection are located on the same side, allowing left or right side configuration simply by flipping the unit: facilitates installation.

Patented Balancing System

Patented pressure taps eliminate the need for an external flow meter and reduce installation time.



Duo

1.2 / 1.4 / 1.9

The Year-Round System



The ultimate solution for year-round energy efficiency

These highly reliable air exchangers improve indoor air quality while providing year-round ventilation. Duo units, besides exchanging polluted indoor air for a continuous supply of fresh outdoor air, are specifically designed to help retain heat in cold climates and reduce the load on cooling systems in warm climates. Optional filter upgrades and wall controls are also available to customize the units to suit the air exchange performance requirements of each user.

- Ideal for renovation and new residential construction
- For consumers looking for ultimate energy efficiency all year long
- Offer air recirculation mode for a constant flow of air to prevent air stagnation (available with the Ultima control)
- Allow optional filter and wall control upgrades
- Equipped with thermal wheel for ultimate home comfort
- Totally reversible units to simplify installation



Features	1.2	1.4	1.9
Rate of air flow (low/high):	64-117 CFM	64-120 CFM	117-180 CFM
Apparent sensible effectiveness at 0°C (32°F):	87% @ 32 l/s (68 CFM)	80% @ 32 l/s (68 CFM)	81% @ 56 l/s (119 CFM)
Apparent sensible effectiveness at -25°C (-13°F):	82% @ 51 l/s (108 CFM)	79% @ 29 l/s (61 CFM)	82% @ 51 l/s (108 CFM)
Dimensions: (Height X Width X Depth)	16-1/2 in. x 30-1/4 in. x 17-1/8 in. (42 cm x 76.8 cm x 43.5 cm)		
Warranty on Parts:	5 years		
Warranty on Thermal Wheel:	5 years		

Main Wall Controls

To help maintain a consistently high level of indoor air quality, Duo units require one of the following main wall controls.



Venta Model
Contains pull out tab with simple instructions and easy-to-use settings. Part # 40310



Supra Model
Includes maintenance light indicator, three operating modes and humidity indicator. Part # 40320



Ultima Model
Includes maintenance light indicator, six operating modes including a recirculation setting, and humidity indicator. Part # 40340

Optional Filters

Pleated Filter:

This non-woven, reinforced cotton and synthetic fabric filter traps more airborne pollutants than the standard filter for improved air quality.

Charcoal Filter:

The activated carbon in this filter effectively traps odors, gases and particles.

Electronic Filter:

This filter's electric field offers superior filtration by capturing 90% of particles as small as 1 micron (1 human hair = 150 microns).



Optional Controls

For a more complete installation and to control ventilation in selected areas, choose one or more of these efficient controls.



60-Minute Mechanical Timer
This timer allows up to 60 minutes of high speed operation. Part # 00910



20/40/60-Minute Push-Button
Provides three convenient settings to help control excess humidity. Part # 03364

External Electrical Box

Easy access to electronics, including microprocessor that is compatible with all controls, on the exterior of unit for easy maintenance and installation.

Permanent Memory

The electronic controls remember which control setting was in use even after a power failure.

HomeShield™ Defrosting System

Prevents ice build-up on recovery module without creating negative indoor air pressure.

Easy to Reach Filters

Washable foam filters effectively filter airborne particles, such as pet dander, lint, dust and mold spores, while protecting the equipment from dust build-up.

Motor Assembly

Can easily be replaced in less than 7 minutes, allowing a simple and fast maintenance.

Door Switch

Door Switch automatically shuts off unit when door is opened for added safety and easy maintenance.

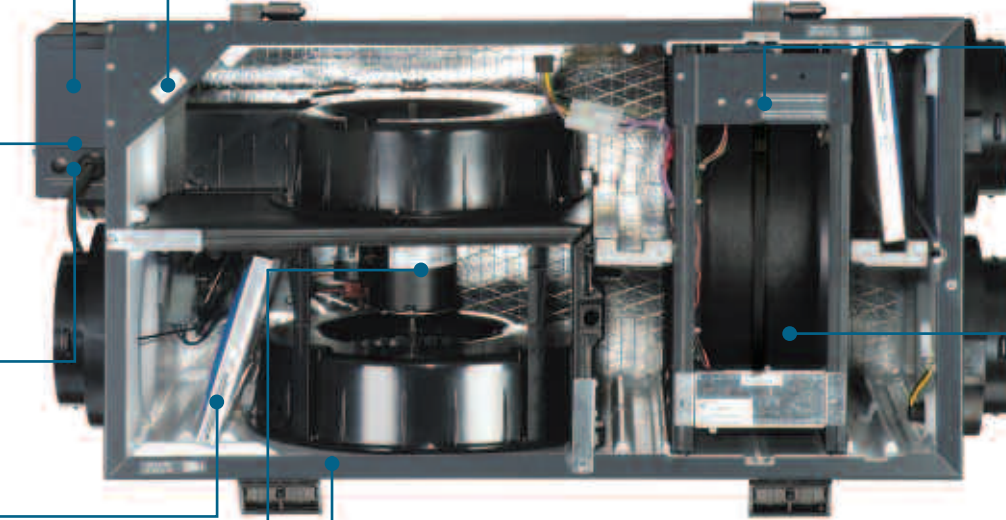

Energy Recovery Wheel

Thermal wheel offers an important capacity to absorb heat and humidity and is assembled in a solid plastic cassette for easy manipulation. Synchronized timing belt offers exceptional reliability thanks to a proven design principle from the automobile industry.

Wheel Maintenance

Enjoy quick and simple maintenance with a thermal wheel that is easy to remove and can be cleaned with a vacuum.

Totally Reversible Unit

The two ports for exterior connection are located on the same side, allowing left or right side configuration simply by flipping the unit: facilitates installation.

Patented Balancing System

Patented pressure taps eliminate the need for an external flow meter and reduce installation time.



HE

1.3 / 1.8 / 2.6

The High Efficiency System



The most powerful and efficient heat recovery performance

High Efficiency residential air exchangers are the most powerful and efficient on the market. Featuring the ultimate heat recovery performance and air flow up to 320 CFM, these high efficiency units deliver unparalleled indoor air quality and excess humidity control in medium to large size homes. These state-of-the-art units also come with feature-rich main and optional wall controls and push-buttons for added functionality and even greater home comfort. If you're willing to spend a little more for the best heat recovery system (HRV) on the market, install a High Efficiency air exchanger.

- The ideal HRV for custom built homes and renovation applications. Can easily exchange air in medium to large size homes
- For consumers living in cold climates who seek superior heat recovery performance compared to all other HRV systems on the market
- Offer air recirculation mode for a constant flow of air to prevent air stagnation (available with the Ultima control)
- Optional controls allow you to customize unit for enhanced performance

Features	1.3	1.8	2.6
Rate of air flow (low/high):	65-130 CFM	115-197 CFM	180-321 CFM
Apparent sensible effectiveness at 0°C (32°F):	92% @ 30 l/s (64 CFM)	95% @ 52 l/s (111 CFM)	94% @ 55 l/s (117 CFM)
Apparent sensible effectiveness at -25°C (-13°F):	89% @ 30 l/s (64 CFM)	88% @ 57 l/s (121 CFM)	89% @ 55 l/s (117 CFM)
Dimensions: (Height X Width X Depth)	27 in. x 21 in. x 24-1/4 in. (68.6 cm x 53.3 cm x 61.6 cm)	42-3/4 in. x 23 in. x 24 in. (108.6 cm x 58.4 cm x 60.1 cm)	
Warranty on Parts:	5 years		5 years
Warranty on Core:	Limited Lifetime		Limited Lifetime



Main Wall Controls

To help maintain a consistently high level of indoor air quality, HE units require one of the following main wall controls.



Venta Model

Contains pull out tab with simple instructions and easy-to-use settings. Part # 40310



Supra Model

Includes maintenance light indicator, three operating modes and humidity indicator. Part # 40320



Ultima Model

Includes maintenance light indicator, six operating modes including a recirculation setting, and humidity indicator. Part # 40340

Optional Controls

For a more complete installation and to control ventilation in selected areas, choose one or more of these efficient controls.



60-Minute Mechanical Timer

This timer allows up to 60 minutes of high speed operation. Part # 00910



20/40/60-Minute Push-Button

Provides three convenient settings to help control excess humidity. Part # 03364

Indoor Air Intake and Exhaust Ports

Diameter of 7 in. or 8 in. (175 mm or 200 mm) ports allow higher CFM rates.

HomeShield™ Defrosting System

Prevents ice build-up on recovery module without creating negative indoor air pressure.

Heat Recovery Core

Offers the best efficiency by warming the incoming fresh, colder air before it is distributed throughout your home.

Core Maintenance

Enjoy simple maintenance with a heat recovery core that can be washed in water.

Motor Assembly

Can be easily replaced for a simple and fast maintenance.



Easy to Reach Filters

Washable foam filters effectively filter airborne particles, such as pet dander, lint, dust and mold spores, while protecting the equipment from dust build-up.

Electrical Box

Easy access to electronics, including microprocessor that is compatible with all controls on the exterior of unit for easy maintenance and installation.

Permanent Memory

The electronic controls remember which control setting was in use even after a power failure.

Door Switch

Door Switch automatically shuts off unit when door is opened for added safety and easy maintenance.

Typical Installations



Types of installations

Any Venmar AVS unit can be easily integrated with an existing forced-air system (furnace) or can be installed independently using one of three typical installations featured below. Homeowners will be satisfied with multiple air intake and air exhaust grilles that bring exceptional ventilation into every room; not just selected areas. Whatever the installation or ventilation requirements, Venmar AVS has the solution to ensure proper ventilation and better indoor air quality.

Options

A variety of options are available to further simplify installation and enhance the efficiency of every Venmar AVS unit.



Tandem® Hood Kit

Needs only one hole in exterior wall. Tandem® Y-shaped transition and single exterior outlet evacuate stale air and bring in fresh air without risk of contamination. 2 models available: 6 in. (15.2 cm) and 7 in. (17.8 cm). (Refer to installation manual for further details.)



Optional Filters

To boost the filtration level, a pleated, charcoal or electronic filter can be added to a unit. (Available with Duo and Solo units only.)

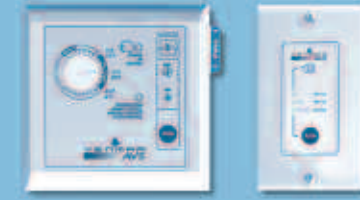

Main and Optional Wall Controls

Complete your installation with a main wall control and one or more optional controls.

Attic Installation*

For Southern States
Depending on your geographical location, an attic installation is possible as long as the temperature is maintained above 10°C (50°F) at all times. Refer to installation manual for further details.

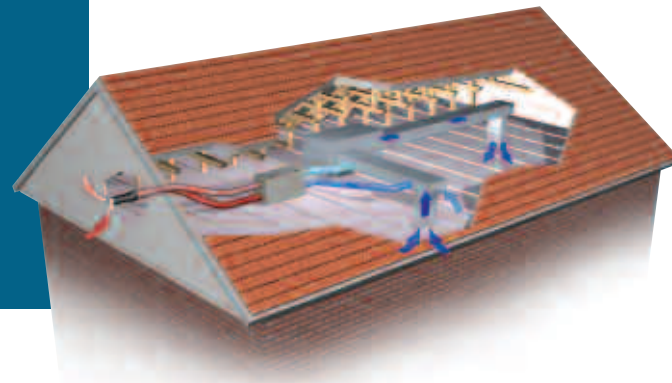

* NOTE: The installation may differ from one unit or home to another

Fully Ducted System*

Primarily for homes with radiant flooring, hot water or electric baseboard heating
Effective because unit captures pollutants at the source and distributes fresh air to living areas



Exhaust Ducted System*

(Source Point Ventilation)
For homes with forced air heating systems or air handlers
Effective because unit captures pollutants at the source

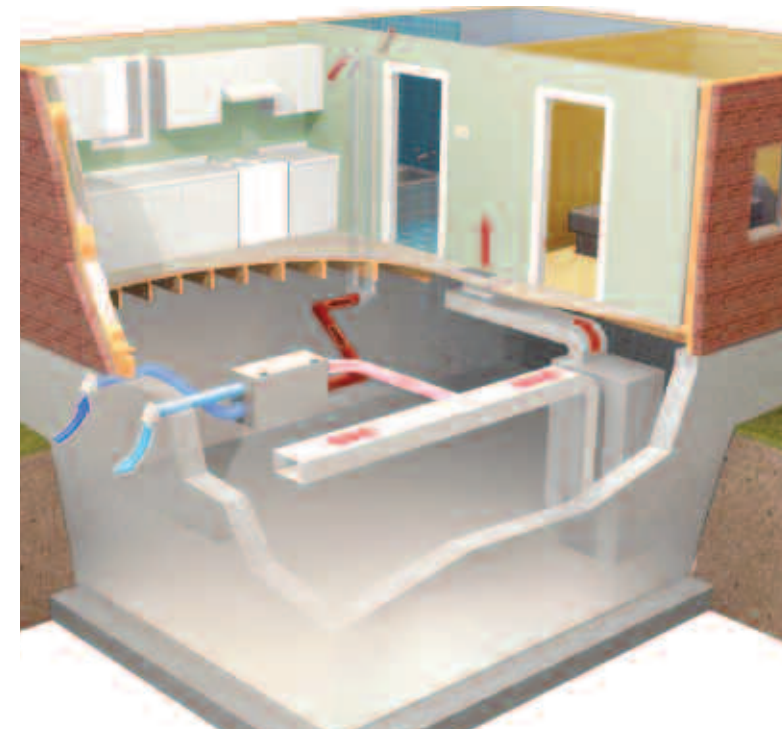

Simplified*

(Volume Ventilation)
For homes with forced air heating systems or air handlers
Easy to install as unit uses existing furnace or air handler ducting

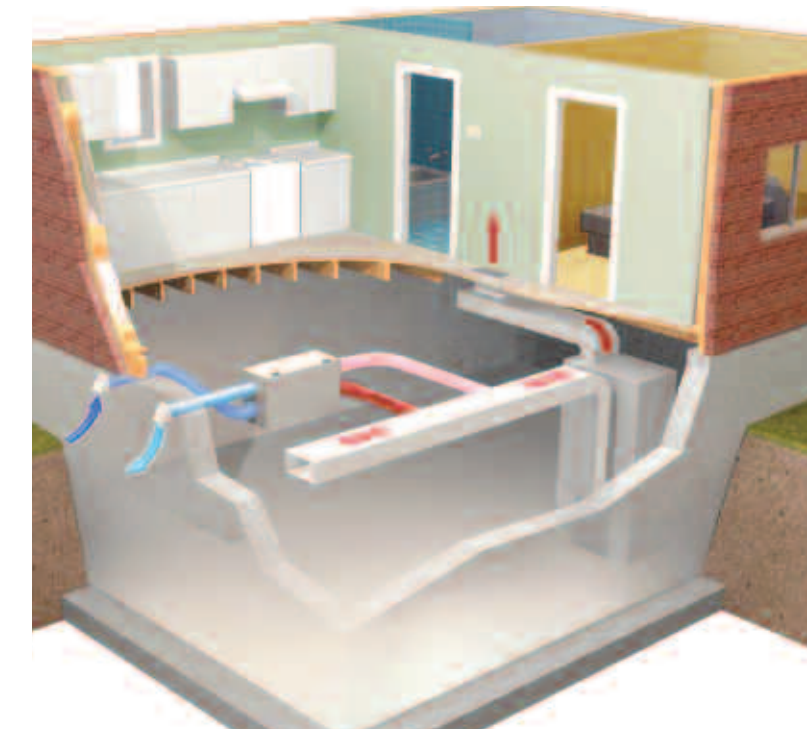

*Note: The furnace blower should always be running when the unit is in operation.